



MOWERS

Vermeer





INCLUDES Q3 CUTTER BAR	TYPE OF MOWER
MC90	Mower conditioner
MC105	Mower conditioner
MC120	Mower conditioner
MC150	Mower conditioner
TM105	Trailed mower
TM120	Trailed mower
TM135	Trailed mower
TM1210	Trailed mower
TM1410	Trailed mower

Q3® CUTTER BAR: **QUALITY TO COUNT ON**

Vermeer offers two different types of shaft-driven cutter bars on hay mowers: standard, and Q3® cutter bars. Both come with a Quick-Clip® blade retention system and 3-year coverage; however, there are differences worth noting.

The Q3 cutter bar, available on select Vermeer mower conditioners and trailed mowers, provides high hay-cutting performance in the field with low horsepower requirements. But what features set the Q3 cutter bar apart?

THE 3 Q’S BEHIND THE Q3 CUTTER BAR:

Q3

- Quick-Clip® blade retention system*
- Quick-Change™ shear ring
- Quick-check oil

TABLE OF CONTENTS:

MC90, MC105, MC120 and MC150 mower conditioners	pg. 4 - 5
Trailed mower comparison chart	pg. 6 - 7
TM710 and TM810 trailed mowers	pg. 8 - 9
TM105, TM120 and TM135 trailed mowers	pg. 10 - 11
TM1200 trailed mowers	pg. 12 - 13
TM1210 and TM1410 trailed mowers	pg. 14 - 15
M5050, M6050, M7050 and M8050 disc mowers	pg. 16 - 17
FM110 front mower and CM295 combination mower	pg. 18 - 19
Product specifications	pg. 20-27

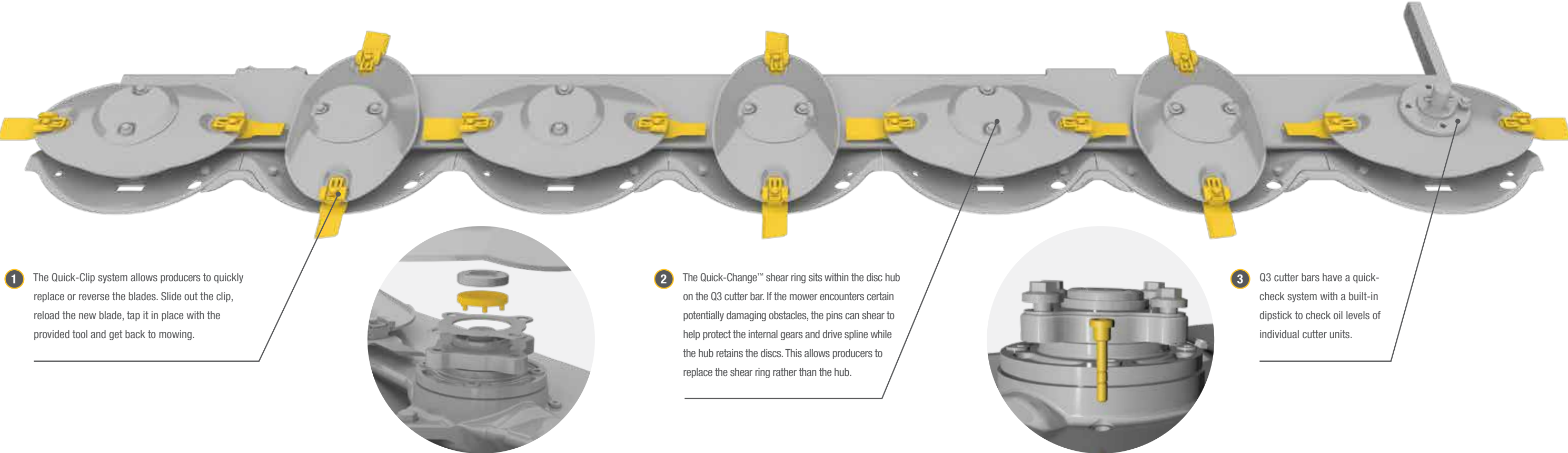

MC90, MC105, MC120 AND MC150 MOWER CONDITIONERS

Meet the Vermeer mower conditioner. Equipped with Q3[®] cutter bars and the option for a patented 2-point Quick Hitch hookup, these mower conditioners offer the durability, common-sense innovations and quality you expect from the hay and forage experts at Vermeer.

PRODUCT	CUTTING WIDTH
MC90 mower conditioner	9 ft (3 m)
MC105 mower conditioner	10.5 ft (3.2 m)
MC120 mower conditioner	12 ft (3.7 m)
MC150 mower conditioner	15 ft (4.6 m)

1 Achieve a consistent, clean cut with hydraulic suspension. With this system, operators can conveniently adjust down pressure based on field conditions with the simple twist of a knob.

2 Say goodbye to a tractor that's only dedicated to mowing for the summer. Two hitch options provide a simple, one-person hookup — the patented drawbar swivel hitch or patented 2-point quick hitch — both with a balanced pivoting drawbar connection to help you get out to the field in no time.

3 Convenient maintenance and long-lasting durability come standard with the Q3 cutter bar. Backed by 3-year cutter bar coverage, three features make it quick and convenient to check and replace key components — the Quick-Clip[®] blade retention system, Quick-Change[™] shear ring and quick-check oil for each individual cutter unit.

4 Adjust to different crops and conditions on the go. Toolless hydraulic pitch adjustment allows operators to change the angle of the blades on the cutter bar to help them achieve maximized yield while minimizing damage to the field.

5 Optimize hay quality with a conditioner type suited for your operation. Steel rollers offer durability and powerful crimping action while rubber rollers focus on leaf retention of the crop.

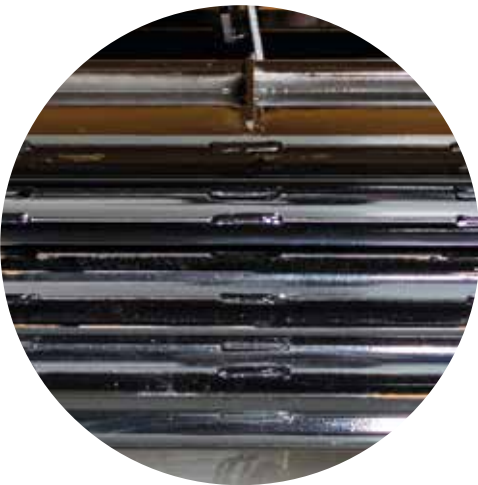



TRAILED MOWER **COMPARISON**

Vermeer offers a wide variety of trailed mowers with cutting widths ranging from 9.2 ft to 20.8 ft (2.8 m to 6.3 m). All these options aren't to make a producer's choice tougher, but so they have the right-sized mower for their operation and productivity needs.

PRODUCT	CUTTING WIDTH	TRANSPORT WIDTH
TM710 trailed mower	9.2 ft (2.8 m)	9.4 ft (2.9 m)
TM810 trailed mower	10.5 ft (3.2 m)	10.8 ft (3.3 m)
TM105 trailed mower	10.7 ft (3.3 m)	10.7 ft (3.3 m)
TM120 trailed mower	12 ft (3.7 m)	12 ft (3.7 m)
TM135 trailed mower	13.6 ft (4.1 m)	13.6 ft (4.1 m)
TM1200 trailed mower	15.5 ft (4.7 m)	8.5 ft (2.6 m)
TM1210 trailed mower	17.7 ft (5.4 m)	9.8 ft (3 m)
TM1410 trailed mower	20.8 ft (6.3 m)	9.8 ft (3 m)



TM710 AND TM810 TRAILED MOWERS

TM710 and TM810 trailed mowers offer simplicity. The hookup procedure is straightforward — toolless adjustments allow producers to set the suspension between fields, and the Quick-Clip® blade retention system lives up to its name. Horsepower requirements of 50 hp (37.3 kW) for the TM610, for example, are an average of 20% lower than comparable 3-point disc mowers.

PRODUCT	CUTTING WIDTH
TM710 trailed mower	9.2 ft (2.8 m)
TM810 trailed mower	10.5 ft (3.2 m)



1 An exclusive rubber torsion suspension design absorbs shock loads and high impacts by reducing cutter bar weight on the ground, allowing it to float and swing up and over field obstacles.

2 The swath width is 80% of the cutter bar width for quick and even dry down, depending on crop type and conditions.

3 A side-pull rotary disc mower design with a hydraulic swing cylinder makes transport convenient from field to field.

4 The CV joint helps increase life of drive line and provides smooth operation.

5 Sleek, low-profile cutter units and wide skid shoes provide a clean, close cut. Thick, .2 in (5 mm) heat-treated blades help provide shatter resistance and long life. Segmented, hex-shaped driveshafts can help with ease of maintenance.

A friction-style clutch is placed close to the very thing it's designed to protect — the cutter bar.





TM105, TM120 AND TM135 TRAILED MOWERS

There's no secret to what ranchers and hay producers want in a trailed mower: durability in the field, premium cut quality and ease of maintenance. That's where these Vermeer trailed mowers hit the sweet spot in terms of features and capabilities. Choose from three cutting widths ranging from 10.7 ft to 13.6 ft (3.3 m to 4.1 m). And although we call them mid-sized mowers, they give producers more than enough cutting width to finish fields in short order.

1 Suspension largely influences a producer's ability to get a consistent cut. This system allows optimal suspension to minimize ground pressure for a clean cut across the field. For varying field conditions, producers can make quick and toolless suspension adjustments. Now they control how they cut.

2 The frame is the backbone of any trailed mower, and this mower is equipped with one of the most robust frames in the field. Durable components like a heavy-duty frame and large tires are ready to withstand varying field conditions for years to come.



3 With a pivoting header gearbox and a CV joint, the mower can operate on the side of or directly behind the tractor. Plus, if producers ever need to mow above an obstacle in the field, they can bump a lever to raise the pitch using the tractor hydraulics. Then bump the lever back down and they're back to the original cut height. All while the mower never leaves the ground. Full control comes with these mid-sized trailed mowers.

4 There are two hitch options to choose from but both provide a convenient, one-person hookup — the patented drawbar swivel hitch or patented 2-point Quick Hitch. Both have a balanced pivoting drawbar connection to make hitching-up a hassle-free, one-person job. Hitch up and mow.

5 Maximize productivity and minimize maintenance time with a heavy-duty, modular, shaft-driven cutter bar. Not only is it backed by the Vermeer 3-year cutter bar coverage, but two features make it quick and convenient to replace key components — the Quick-Clip® blade retention system and Quick-Change™ shear ring. Get back up and mowing in the field.

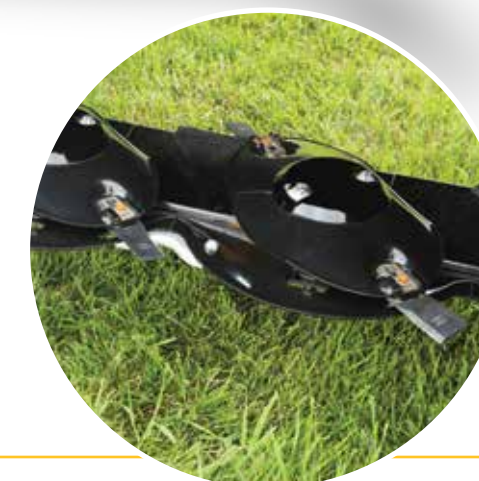

TM1200 TRAILED MOWER

The TM1200 trailed mower is convenient to use and has an impressive cutting width of 15.5 ft (4.7 m) with a minimal horsepower requirement of 85 hp (63 kW).

1 The hydraulic cutter-bar pitch control sets the cutting height to minimize streaking and allows producers to adjust for different crops and conditions — no tools required.

2 The TM1200 quickly folds down to 8.5 ft (2.6 m) to efficiently maneuver through gates when traveling from field to field, while the 2-point hookup accommodates both category II and III N hitches.



3 The hydraulic suspension system works in conjunction with the split cutter bar to reduce cutter bar weight on the ground, increase flex and allow the TM1200 to follow ground contour.

4 Float over fields and contoured terrain with a nitrogen-charged accumulator flotation system that adjusts for varying field and crop conditions.

TM1210 AND TM1410 TRAILED MOWERS

Vermeer TM1210 and TM1410 trailed mowers are ideal for those who want to cut more hay in less time with convenient features that can help take the stress out of operating, transporting and maintaining a large trailed mower.

1 Optional large flotation tires are available on both the TM1210 and TM1410. Flotation tires can help limit compaction in the field and allow producers to mow in wetter-than-normal conditions.

2 The TM1210 and TM1410 come with a split Q3[®] cutter bar. The two independent cutter bar units work with the suspension system, allowing the mower to follow uneven ground contour. Each cutter bar can flex independently to pivot up and over hidden obstacles.

4 A nitrogen-charged accumulator suspension system makes it efficient to adjust for various crops and conditions, and provides ground-following cutter bar balance and a consistent pitch. The system allows producers to charge to an established setting every time.

5 The TM1210 offers cutting widths of up to 17.7 ft (5.4 m), and the TM1410 offers cutting widths of up to 20.8 ft (6.3 m).

6 A patented 2-point Quick Hitch hookup is designed to allow one person to hook up the mower. It also provides high ground clearance to help avoid obstructions while in the field.



This image is for illustration purposes only. Curtains and shielding have been removed. Never operate equipment without the appropriate shielding in place.



3 These machines offer big-time productivity, big-time convenience and a narrow 9.1-ft (2.8-m) transport width with standard tires or 9.8-ft (3-m) transport width with optional flotation tires.



M5050, M6050, M7050 AND M8050 DISC MOWERS

Some say disc mowers are all the same, but it's the little things that make the difference and help eliminate major pain points. Built in Pella, Iowa, the M5050, M6050, M7050 and M8050 disc mowers feature a patented Quick Hitch hookup. This one-person job only takes a few steps — then it's off to the field.

PRODUCT	PTO HP RECOMMENDED	CUTTING WIDTH
M5050 disc mower	45 hp (34 kW)	6.8 ft (2.1 m)
M6050 disc mower	60 hp (45 kW)	7.8 ft (2.4 m)
M7050 disc mower	70 hp (52 kW)	9.2 ft (2.8 m)
M8050 disc mower	80 hp (60 kW)	10.5 ft (3.2 m)

1 Hooking up a 3-point disc mower isn't the tedious chore it used to be. The patented Quick Hitch hookup is a one-person hookup: Back up the tractor, hook up the disc mower with the Quick Hitch and it's ready to go.

2 The cutter bar is the backbone of 50-series disc mowers. A tapered, low-profile cutter bar delivers a close, clean cut, which minimizes streaking and helps improve performance across a variety of crops.

Self-contained cutter units come prepared with their own sets of gears, bearings and lubricant to help extend operating life. Even at increased working angles, grease continues to lubricate the gears and won't flow to the other side of the bar. Plus, it's backed by the Vermeer 3-year cutter bar coverage.

3 Maintenance is made convenient with the Quick-Clip® blade retention system, which lets producers change and turn blades in seconds.

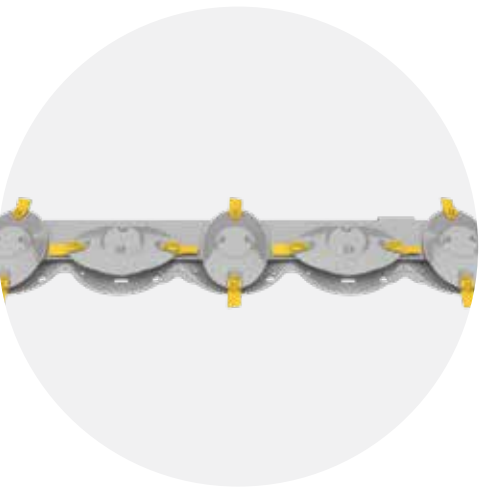



FM110 FRONT MOWER AND CM295 COMBINATION MOWER

Exceptional efficiency and productivity? Sign me up. Vermeer triple mowers are perfect for large operations who demand productivity, durability and versatile adaptation. The FM110 front mower and the CM295 combination mower combine to provide you with a triple mower with a working width of up to 29.8 ft (9.1 m) capable of covering up to 35 acres per hour.*

PRODUCT	PTO HP RECOMMENDED	CUTTING WIDTH
FM110 front mower	80 hp (60 kW)	10.9 ft (3.3 m)
FM110 front mower with rubber roller conditioner	110 hp (81 kW)	10.9 ft (3.3 m)
FM110 front mower with flail conditioner	110 hp (81 kW)	10.9 ft (3.3 m)
CM295 combination mower	200 hp (150 kW) when used with FM110	29.3 ft (8.9 m)
CM295 combination mower with rubber roller conditioner	240 hp (180 kW) when used with FM110	29.8 ft (9.1 m)
CM295 combination mower with flail conditioner	230 hp (170 kW) when used with FM110	29.3 ft (8.9 m)



1 Achieve efficiency and a premium cut with a robust cutter bar made with 4-mm (.16-in) specially shaped pods that allow rapid forage flow, even when on slopes. Each pod is made from abrasion-resistant Hardox® steel to provide you with long-lasting performance acre after acre.



2 A clean, precise cut is the product of excellent ground adaptation thanks to the hydraulic suspension on the FM110 front mower. This allows for a consistent cut on a variety of terrains and conditions. Additionally, the suspension pressure can be easily changed without the use of any tools for optimal performance.

3 Choose the best option for your specific needs with options for a rubber roller conditioner, steel flail conditioner or a mower without a conditioner.



4 Gain complete control with the pull-type front hitch. With more than 20 in (51 cm) of vertical movement, it offers flexibility and protection, letting you operate more confidently.

5 Hydraulic suspension on each side of the combination mower ensures excellent adaptation to the ground and a precise cut and clean forage in a variety of terrains and in all conditions. The relief rate can be easily and quickly adjusted before or during mowing.

SPECIFICATION	MC90 MOWER CONDITIONER	MC105 MOWER CONDITIONER	MC120 MOWER CONDITIONER	MC150 MOWER CONDITIONER
DIMENSIONS AND WEIGHTS				
Transport height	73 in (180 cm)	73 in (180 cm)	73 in (180 cm)	73 in (180 cm)
Transport width	8.6 ft (2.6 m)	9.8 ft (3 m)	11.6 ft (3.5 m)	15.3 ft (4.7 m)
Transport length	19.8 ft (6 m)	20.2 ft (6.2 m)	27.5 ft (8.4 m)	29.3 ft (8.9 m)
Cutting width	9 ft (3 m)	10.5 ft (3.2 m)	12 ft (3.7 m)	15 ft (4.6 m)
Working height	73 in (180 cm)	73 in (180 cm)	73 in (180 cm)	73 in (180 cm)
Working width	11.4 ft (3.5 m)	12.8 ft (3.9 m)	14.1 ft (4.3 m)	15.3 ft (4.7 m)
Mower swung out offset	54 in (140 cm)	62 in (160 cm)	70 in (180 cm)	80 in (200 cm)
Cutter bar lift height clearance	17 in (43 cm)	17 in (43 cm)	17 in (43 cm)	17 in (43 cm)
Total weight	4,800 lb (2,200 kg)	5,140 lb (2,330 kg)	6,080 lb (2,760 kg)	7,000 lbs (3,200 kg)
Tongue weight	1,340 lb (610 kg)	1,340 lb (610 kg)	1,520 lb (690 kg)	1,700 lb (770 kg)
Suspension	Nitrogen-charged accumulator suspension system	Nitrogen-charged accumulator suspension system	Nitrogen-charged accumulator suspension system	Nitrogen-charged accumulator suspension system
Torque protection	Friction over — running clutch — cutter bar Banded V-belt — rollers	Friction over — running clutch — cutter bar Banded V-belt — rollers	Friction over — running clutch — cutter bar Banded V-belt — rollers	Friction over — running clutch — cutter bar Banded V-belt — rollers
Tires	11L-15	12.5L-15	31X13.5-15	33X15.5-16.5
TRACTOR REQUIREMENTS				
Tongue/hitch	Drawbar with swivel gearbox OR 2-point with swivel gearbox, category II or III N	Drawbar with swivel gearbox OR 2-point with swivel gearbox, category II or III N	Drawbar with swivel gearbox OR 2-point with swivel gearbox, category II or III N	Drawbar with swivel gearbox OR 2-point with swivel gearbox, category II or III N
Drive PTO	540 rpm	540 rpm	1,000 rpm	1,000 rpm
PTO horsepower recommended	65 hp (48 kW)	75 hp (56 kW)	90 hp (70 kW)	105 hp (78 kW)
Hydraulic type	2 double-acting	2 double-acting	2 double-acting	2 double-acting
Hydraulic pressure	1,900 psi (130 bar)	1,900 psi (130 bar)	1,900 psi (130 bar)	2,200 psi (150 bar)
Hydraulic flow rate	6 gpm (23 L/min)	6 gpm (23 L/min)	6 gpm (23 L/min)	6 gpm (23 L/min)

SPECIFICATION	MC90 MOWER CONDITIONER	MC105 MOWER CONDITIONER	MC120 MOWER CONDITIONER	MC150 MOWER CONDITIONER
CUTTER BAR				
Cutter bar type	Q3® cutter bar	Q3® cutter bar	Q3® cutter bar	Q3® cutter bar
Cut height	1 in - 8 in (2.5 cm - 20 cm)	1 in - 8 in (2.5 cm - 20 cm)	1 in - 8 in (2.5 cm - 20 cm)	1 in - 8 in (2.5 cm - 20 cm)
Number of discs	6	7	8	10
Disc diameter	23 in (58 cm)	23 in (58 cm)	23 in (58 cm)	23 in (58 cm)
Disc speed	2,700 rpm	2,700 rpm	2,700 rpm	2,700 rpm
Number of blades	12	14	16	20
Angle adjustment	Hydraulic pitch control	Hydraulic pitch control	Hydraulic pitch control	Hydraulic pitch control
Quick Clip® blade retention system	Standard	Standard	Standard	Standard
Quick-Change™ shear ring	Standard	Standard	Standard	Standard
Curtain material	1,400 gm/m² polyester woven material with flexible PVC covering	1,400 gm/m² polyester woven material with flexible PVC covering	1,400 gm/m² polyester woven material with flexible PVC covering	1,400 gm/m² polyester woven material with flexible PVC covering
3-year limited cutter bar coverage	Standard	Standard	Standard	Standard
FEATURES				
Skid shoes	Optional wear skids	Optional wear skids	Optional wear skids	Optional wear skids
Highway lights	Standard	Standard	Standard	Standard
Platform (for tall crops)	Standard	Standard	Standard	Standard
Topping high cut kit	Standard	Standard	Standard	Standard
ROLLER CONDITIONER				
Type	Intermeshing steel rollers or rubber rollers	Intermeshing steel rollers or rubber rollers	Intermeshing steel rollers or rubber rollers	Intermeshing steel rollers or rubber rollers
Conditioner drive	4-band banded V-belt	4-band banded V-belt	4-band banded V-belt	4-band banded V-belt
Conditioner width	83 in (210 cm)	102 in (260 cm)	118 in (300 cm)	118 in (300 cm)
Roller diameter	9.3 in (23.6 cm)	9.3 in (23.6 cm)	9.3 in (23.6 cm)	9.3 in (23.6 cm)
Roller speed	740 rpm	740 rpm	740 rpm	740 rpm
Windrow width minimum	36 in (91 cm)	40 in (100 cm)	48 in (120 cm)	62 in (160 cm)
Windrow width maximum	82 in (210 cm)	95 in (240 cm)	112 in (280 cm)	112 in (280 cm)

SPECIFICATION	TM710 TRAILED MOWER	TM810 TRAILED MOWER
DIMENSIONS AND WEIGHTS		
Transport length	15.3 ft (4.7 m)	15.3 ft (4.7 m)
Transport width	9.4 ft (2.9 m)	10.8 ft (3.3 m)
Transport height	46 in (120 cm)	46 in (120 cm)
Cutting width	9.2 ft (2.8 m)	10.5 ft (3.2 m)
Working length	14.3 ft (4.3 m)	14.3 ft (4.3 m)
Working width	13.6 ft (4.1 m)	14.9 ft (4.5 m)
Working height	46 in (120 cm)	46 in (120 cm)
Total weight	2,200 lb (997.9 kg)	2,300 lb (1,043.3 kg)
Tongue weight	630 lb (290 kg)	660 lb (300 kg)
Suspension	Rubber torsion	Rubber torsion
Torque protection	Driveline: friction disc clutch	Driveline: friction disc clutch
Tires	27x9.5-15	27x9.5-15
TRACTOR REQUIREMENTS		
Tongue/hitch	Drawbar	Drawbar
Drive PTO	540 rpm	540 rpm
PTO horsepower recommended	55 hp (41 kW)	60 hp (45 kW)
Hydraulic type	2 double-acting (1 double-acting with optional kit)	2 double-acting (1 double-acting with optional kit)
Hydraulic pressure	1,250 psi (86 bar)	1,250 psi (86 bar)
Hydraulic flow rate	6 gpm (20 L/min)	6 gpm (20 L/min)
CUTTER BAR		
Cutter bar type	Standard	Standard
Cut height	1.3 in - 3 in (3.3 cm - 7.6 cm)	1.3 in - 3 in (3.3 cm - 7.6 cm)
Number of discs	7	8
Disc diameter	19.7 in (50 cm)	19.7 in (50 cm)
Disc speed	2,797 rpm	2,797 rpm
Number of blades	14	16
Angle adjustment	Manual turnbuckle	Manual turnbuckle
Quick Clip® blade retention system	Standard	Standard
Curtain material	1-ply 1/8-in (3-mm) rubber	1-ply 1/8-in (3-mm) rubber
3-year limited cutter bar warranty	Standard	Standard
FEATURES		
Optional swath formation	Optional swath board	Optional swath board
Skid shoes	Standard modular independent skid shoes; optional topping wear skids	Standard modular independent skid shoes; optional topping wear skids

SPECIFICATION	TM105 TRAILED MOWER	TM120 TRAILED MOWER	TM135 TRAILED MOWER
DIMENSIONS AND WEIGHTS			
Transport length	18.2 ft (5.5 m)	18.2 ft (5.5 m)	18.2 ft (5.5 m)
Transport width	10.7 ft (3.3 m)	12 ft (3.7 m)	13.6 ft (4.1 m)
Transport height	61 in (150 cm)	61 in (150 cm)	61 in (150 cm)
Cutting width	10.7 ft (3.3 m)	12 ft (3.7 m)	13.6 ft (4.1 m)
Working length	17.2 ft (5.2 m)	17.2 ft (5.2 m)	17.2 ft (5.2 m)
Working width	11.4 ft (3.4 m)	12.7 ft (3.9 m)	14.3 ft (4.3 m)
Working height	61 in (150 cm)	61 in (150 cm)	61 in (150 cm)
Mower swung out offset	50 in (127 cm)	50 in (127 cm)	50 in (127 cm)
Cutter bar lift height clearance	16 in (41 cm)	16 in (41 cm)	16 in (41 cm)
Total weight	3,300 lb (1,500 kg)	3,500 lb (1,600 kg)	3,600 lb (1,600 kg)
Tongue weight	1,200 lb (540 kg)	1,200 lb (540 kg)	1,200 lb (540 kg)
Suspension	Hydraulic	Hydraulic	Hydraulic
Torque protection	Driveline: friction disc clutch	Driveline: friction disc clutch	Driveline: friction disc clutch
Tires	11L-15	31x13.5-15	31x13.5-16
TRACTOR REQUIREMENTS			
Tongue/hitch	Drawbar with swivel gearbox OR 2-point with swivel gearbox, category II or III N	Drawbar with swivel gearbox OR 2-point with swivel gearbox, category II or III N	Drawbar with swivel gearbox OR 2-point with swivel gearbox, category II or III N
Drive PTO	540 rpm	540 rpm	540 rpm or 1,000 rpm
PTO horsepower recommended	60 hp (45 kW)	65 hp (48 kW)	70 hp (52 kW)
Hydraulic type	2 remote, single-acting lift, double-acting swing	2 remote, single-acting lift, double-acting swing	2 remote, single-acting lift, double-acting swing
Hydraulic pressure	1,900 psi (131 bar)	1,900 psi (131 bar)	1,900 psi (131 bar)
Hydraulic flow rate	6 gpm (20 L/min)	6 gpm (20 L/min)	6 gpm (20 L/min)
CUTTER BAR			
Cutter bar type	Q3® cutter bar	Q3® cutter bar	Q3® cutter bar
Cut height	1 in - 3 in (2.5 cm - 7.6 cm)	1 in - 3 in (2.5 cm - 7.6 cm)	1 in - 3 in (2.5 cm - 7.6 cm)
Number of discs	7	8	9
Disc diameter	23 in (58.4 cm)	23 in (58.4 cm)	23 in (58.4 cm)
Disc speed	2,700 rpm	2,700 rpm	2,700 rpm
Number of blades	14	16	18
Angle adjustment	Hydraulic pitch control	Hydraulic pitch control	Hydraulic pitch control
Quick Clip® blade retention system	Standard	Standard	Standard
Quick-Change™ shear ring	Standard	Standard	Standard
Curtain material	1,400 gm/m² polyester woven material with flexible PVC covering	1,400 gm/m² polyester woven material with flexible PVC covering	1,400 gm/m² polyester woven material with flexible PVC covering
3-year limited cutter bar warranty	Standard	Standard	Standard
FEATURES			
Optional swath formation	Optional right crop divider, standard right swath wheel	Optional right crop divider, standard right swath wheel	Optional right crop divider, standard right swath wheel
Skid shoes	Standard modular independent skid shoes; optional topping shoes and wear skids	Standard modular independent skid shoes; optional topping shoes and wear skids	Standard modular independent skid shoes; optional topping shoes and wear skids
Highway lights	Optional	Standard	Standard

SPECIFICATION	TM1200 TRAILED MOWER	TM1210 TRAILED MOWER	TM1410 TRAILED MOWER
DIMENSIONS AND WEIGHTS			
Transport length	22 ft (6.7 m)	25.2 ft (7.7 m)	25.2 ft (7.7 m)
Transport width	8.5 ft (2.6 m)	9.8 ft (3 m)	9.8 ft (3 m)
Transport height	78 in (200 cm)	76 in (190 cm)	76 in (190 cm)
Cutting width	15.5 ft (4.7 m)	17.7 ft (5.4 m)	20.8 ft (6.3 m)
Working length	18 ft (5.5 m)	19.8 ft (6 m)	19.8 ft (6 m)
Working width	22 ft (6.7 m)	23.9 ft (7.3 m)	27.1 ft (8.3 m)
Working height	78 in (200 cm)	76 in (190 cm)	76 in (190 cm)
Total weight	5,900 lb (2,700 kg)	6,275 lb (2,800 kg)	6,660 lb (3,020 kg)
Tongue weight	1,580 lb (720 kg)	1,820 lb (830 kg)	1,940 lb (880 kg)
Suspension	Hydraulic	Hydraulic	Hydraulic
Torque protection	Driveline: friction disc clutch	Driveline: friction disc clutch	Driveline: friction disc clutch
Tires	31x13.5-15	480/45x17 flotation tire	480/45x17 flotation tire
TRACTOR REQUIREMENTS			
Tongue/hitch	2-point with swivel gearbox, category II or III N	2-point Quick Hitch with swivel gearbox, category II or III N	2-point Quick Hitch with swivel gearbox, category II or III N
Drive PTO	540 rpm or 1,000 rpm	540 rpm or 1,000 rpm	1,000 rpm
PTO horsepower recommended	85 hp (63 kW)	95 hp (71 kW)	105 hp (78 kW)
Hydraulic type	2 double-acting	2 double-acting	2 double-acting
Hydraulic pressure	1,500 psi (100 bar)	1,850 psi (130 bar)	1,850 psi (130 bar)
Hydraulic flow rate	6 gpm (20 L/min)	6 gpm (20 L/min)	6 gpm (20 L/min)
CUTTER BAR			
Cutter bar type	Standard	Q3® cutter bar	Q3® cutter bar
Cut height	1.3 in - 3 in (3.3 cm - 7.6 cm)	1 in - 3 in (2.5 cm - 7.6 cm)	1 in - 3 in (2.5 cm - 7.6 cm)
Number of discs	12	12	14
Disc diameter	19.7 in (50 cm)	23 in (58 cm)	23 in (58 cm)
Disc speed	2,950 rpm	2,690 rpm	2,690 rpm
Number of blades	24	24	28
Angle adjustment	Hydraulic pitch control	Hydraulic pitch control	Hydraulic pitch control
Quick Clip® blade retention system	Standard	Standard	Standard
Quick-Change™ shear ring	NA	Standard	Standard
Curtain material	1,400 gm/m² polyester woven material with flexible PVC covering	1,400 gm/m² polyester woven material with flexible PVC covering	1,400 gm/m² polyester woven material with flexible PVC covering
3-year limited cutter bar warranty	Standard	Standard	Standard
FEATURES			
Optional swath formation	Optional swath board	Optional swath wheel	Optional swath wheel
Skid shoes	Standard modular independent skid shoes; optional topping wear skids	Standard modular independent skid shoes; optional topping wear skids	Standard modular independent skid shoes; optional topping wear skids
Highway lights	Standard	Standard	Standard

SPECIFICATION	M5050 DISC MOWER	M6050 DISC MOWER	M7050 DISC MOWER	M8050 DISC MOWER
DIMENSIONS AND WEIGHTS				
Transport length	6.5 ft (2 m)	6.5 ft (2 m)	6.5 ft (2 m)	6.5 ft (2 m)
Transport width	7.8 ft (2.4 m)	7.8 ft (2.4 m)	7.8 ft (2.4 m)	7.8 ft (2.4 m)
Cutting width	6.8 ft (2.1 m)	7.8 ft (2.4 m)	9.2 ft (2.8 m)	10.5 ft (3.2 m)
Working length	6.5 ft (2 m)	6.5 ft (2 m)	6.5 ft (2 m)	6.5 ft (2 m)
Working width	6.8 ft (2.1 m)	7.8 ft (2.4 m)	9.2 ft (2.8 m)	10.5 ft (3.2 m)
Total weight	1,135 lb (514.8 kg)	1,215 lb (551 kg)	1,291 lb (585.6 kg)	1,380 lb (626 kg)
Torque protection	Driveline: V-belt	Driveline: V-belt	Driveline: V-belt	Driveline: V-belt
TRACTOR REQUIREMENTS				
Tongue/hitch	3-point Quick Hitch, category II or III N	3-point Quick Hitch, category II or III N	3-point Quick Hitch, category II or III N	3-point Quick Hitch, category II or III N
Drive PTO	540 rpm	540 rpm	540 rpm	540 rpm
PTO horsepower recommended	45 hp (34 kW)	60 hp (45 kW)	70 hp (52 kW)	80 hp (60 kW)
Hydraulic type	1 auxiliary remote, single-acting	1 auxiliary remote, single-acting	1 auxiliary remote, single-acting	1 auxiliary remote, single-acting
Hydraulic pressure	1,700 psi (120 bar)	1,700 psi (120 bar)	2,000 psi (140 bar)	2,000 psi (140 bar)
Hydraulic flow rate	6 gpm (20 L/min)	6 gpm (20 L/min)	6 gpm (20 L/min)	6 gpm (20 L/min)
CUTTER BAR				
Cutter bar type	Standard	Standard	Standard	Standard
Cut height	1.3 in - 3.9 in (3.3 cm - 9.9 cm)	1.3 in - 3.9 in (3.3 cm - 9.9 cm)	1.3 in - 3.9 in (3.3 cm - 9.9 cm)	1.3 in - 3.9 in (3.3 cm - 9.9 cm)
Number of discs	5	6	7	8
Disc diameter	19.7 in (50 cm)	19.7 in (50 cm)	19.7 in (50 cm)	19.7 in (50 cm)
Disc speed	2,850 rpm	2,850 rpm	2,850 rpm	2,850 rpm
Number of blades	10	12	14	16
Angle adjustment	Top-link on 3-point	Top-link on 3-point	Top-link on 3-point	Top-link on 3-point
Quick Clip® blade retention system	Standard	Standard	Standard	Standard
Curtain material	1,400 gm/m² polyester woven material with flexible PVC covering	1,400 gm/m² polyester woven material with flexible PVC covering	1,400 gm/m² polyester woven material with flexible PVC covering	1,400 gm/m² polyester woven material with flexible PVC covering
3-year limited cutter bar warranty	Standard	Standard	Standard	Standard
FEATURES				
Optional swath formation	Optional crop divider; optional crop divider and swath wheel combination	Optional crop divider; optional crop divider and swath wheel combination	Optional crop divider; optional crop divider and swath wheel combination	Optional crop divider; optional crop divider and swath wheel combination
Skid shoes	Optional topping skid shoes; optional wear skids	Optional topping skid shoes; optional wear skids	Optional topping skid shoes; optional wear skids	Optional topping skid shoes; optional wear skids

Specification	FM110 Front Mower	FM110 Front Mower with Rubber Roller Conditioner	FM110 Front Mower with Steel Flail Conditioner
Dimensions and Weights			
Transport width	10.8 ft (3.3 m)	10.8 ft (3.3 m)	10.8 ft (3.3 m)
Transport length	6.3 ft (1.9 m)	6.3 ft (1.9 m)	6.3 ft (1.9 m)
Cutting width	10.9 ft (3.3 m)	10.9 ft (3.3 m)	10.9 ft (3.3 m)
Working height	60 in (1.5 m)	60 in (1.5 m)	60 in (1.5 m)
Working width	13 ft (3.9 m)	13 ft (3.9 m)	13 ft (3.9 m)
Working length	6.3 ft (1.9 m)	6.3 ft (1.9 m)	6.3 ft (1.9 m)
Cutter bar lift height clearance	20 in (51 cm)	20 in (51 cm)	20 in (51 cm)
Total weight	1,980 lb (898 kg)	2,720 lb (1,234 kg)	2,450 lb (1,111 kg)
Suspension	Hydraulic	Hydraulic	Hydraulic
Torque protection	Friction and over-running clutch	Friction and over-running clutch	Friction and over-running clutch
Tractor Requirements			
Tongue/hitch	Front 3-point, CAT II	Front 3-point, CAT II	Front 3-point, CAT II
Drive PTO	1,000 rpm	1,000 rpm	1,000 rpm
PTO horsepower recommended	80 hp (60 kW)	110 hp (81 kW)	110 hp (81 kW)
Hydraulic type	1 double-acting	1 double-acting	1 double-acting
Hydraulic pressure	2,030 - 2,900 psi (140 - 200 bar)	2,030 - 2,900 psi (140 - 200 bar)	2,030 - 2,900 psi (140 - 200 bar)
Cutter Bar			
Cutter bar type	Gear bed cutter bar	Gear bed cutter bar	Gear bed cutter bar
Cut height	1.6 in – 2.8 in (4 cm – 7 cm)	1.6 in – 2.8 in (4 cm – 7 cm)	1.6 in – 2.8 in (4 cm – 7 cm)
Number of discs	8	8	8
Disc speed	3,000 rpm	3,000 rpm	3,000 rpm
Number of blades	16	16	16
Angle adjustment	Top-link on 3-point	Top-link on 3-point	Top-link on 3-point
Quick change blades	Standard	Standard	Standard
Shear protection	Standard	Standard	Standard
Features			
Swath formation	Swath wheels	Swath shields	Swath shields or fins
Skid shoes	Standard wear skids, optional topping skids	Standard wear skids, optional topping skids	Standard wear skids, optional topping skids
Topping high cut kit	Optional topping skids	Optional topping skids	Optional topping skids
Conditioner			
Conditioner type	NA	Intermeshing rubber rollers	Steel V-tine
Conditioner drive	NA	(3) V-belt	(3) V-belt
Conditioner width	NA	105 in (2.7 m)	105 in (2.7 m)
Conditioner diameter	NA	Roller: 8.9 in (22.5 cm)	19 in (49 cm)
Conditioner speed	NA	750 rpm	Standard — 1,000 rpm; Optional — 750 rpm
Windrow width minimum	NA	44 in (1.1 m)	75 in (1.9 m)
Windrow width maximum	NA	91 in (2.3 m)	106 in (2.7 m)

Specification	CM295 Combination Mower	CM295 Combination Mower with Rubber Roller Conditioner	CM295 Combination Mower with Steel Flail Conditioner
Dimensions and Weights			
Transport height	157.5 in (400 cm)	157.5 in (400 cm)	157.5 in (400 cm)
Transport width — standard	10 ft (3 m)	10 ft (3 m)	10 ft (3 m)
Transport length	7.2 ft (2.2 m)	8.4 ft (2.6 m)	8.4 ft (2.6 m)
Cutting width	29.3 ft (8.9 m)	29.8 ft (9.1 m)	29.3 ft (8.9 m)
Working height	60 in (1.5 m)	60 in (1.5 m)	60 in (1.5 m)
Working width	32 ft (9.7 m)	32 ft (9.7 m)	32 ft (9.7 m)
Working length	7.2 ft (2.2 m)	8.4 ft (2.6 m)	8.4 ft (2.6 m)
Cutter bar lift height clearance	22 in (55 cm)	22 in (55 cm)	22 in (55 cm)
Total weight	5,159 lb (2,340 kg)	6,810 lb (3,089 kg)	6,658 lb (3,020 kg)
Suspension	Hydraulic	Hydraulic	Hydraulic
Torque protection	Friction and over-running clutch	Friction and over-running clutch	Friction and over-running clutch
Tractor Requirements			
Tongue/hitch	Rear 3-point, CAT III or CAT 4N	Rear 3-point, CAT III or CAT 4N	Rear 3-point, CAT III or CAT 4N
Drive PTO	1,000 rpm	1,000 rpm	1,000 rpm
PTO horsepower recommended	200 hp (147 kW) when used with front mower	240 hp (176 kW) when used with front mower	230 hp (169 kW) when used with front mower
Hydraulic type	2 double-acting float option, 1 single-acting	2 double-acting float option, 1 single-acting	2 double-acting float option, 1 single-acting
Hydraulic pressure	2,030 psi (140 bar)	2,030 psi (140 bar)	2,030 psi (140 bar)
Cutter Bar			
Cutter bar type	Gear bed cutter bar	Gear bed cutter bar	Gear bed cutter bar
Cut height	1.6 in – 2.8 in (4 cm – 7 cm)	1.6 in – 2.8 in (4 cm – 7 cm)	1.6 in – 2.8 in (4 cm – 7 cm)
Number of discs	16	16	16
Disc speed	3,000 rpm	3,000 rpm	3,000 rpm
Number of blades	32	32	32
Angle adjustment	Top-link on 3-point	Top-link on 3-point	Top-link on 3-point
Quick change blades	Standard	Standard	Standard
Shear protection	Standard	Standard	Standard
Features			
Swath formation	Swath wheels	Swath shields	Swath shields or fins
Skid shoes	Standard wear skids, optional topping skids	Standard wear skids, optional topping skids	Standard wear skids, optional topping skids
Highway lights	Standard	Standard	Standard
Topping high cut kit	Optional topping skids	Optional topping skids	Optional topping skids
Conditioner			
Conditioner type	NA	Intermeshing rubber rollers	Steel V-tine
Conditioner drive	NA	(3) V-belt	(3) V-belt
Conditioner width	NA	(2) 105 in (2.7 m)	(2) 105 in (2.7 m)
Conditioner diameter	NA	Roller: 8.9 in (22.5 cm)	19 in (49 cm)
Conditioner speed	NA	750 rpm	Standard — 1,000 rpm; Optional — 750 rpm
Windrow width minimum	NA	(2) 44 in (1.1 m)	(2) 75 in (1.9 m)
Windrow width maximum	NA	(2) 91 in (2.3 m)	(2) 106 in (2.7 m)



Vermeer Corporation
1410 Vermeer Road East
Pella, Iowa 50219
800-370-3659 • vermeer.com

Vermeer Corporation reserves the right to make changes in engineering, design and specifications; add improvements; or discontinue manufacturing at any time without notice or obligation.

Equipment and depictions shown are for illustrative purposes only and may display optional accessories or components specific to their global region. Please contact your local Vermeer dealer for more information on machine specifications.

Vermeer, the Vermeer logo, Quick-Clip, Quick-Change and Q3 are trademarks of Vermeer Manufacturing Company in the U.S. and/or other countries.

© 2025 Vermeer Corporation. All Rights Reserved.

PN#510505090

MOWERS